

### 1. PRODUCT OVERVIEW

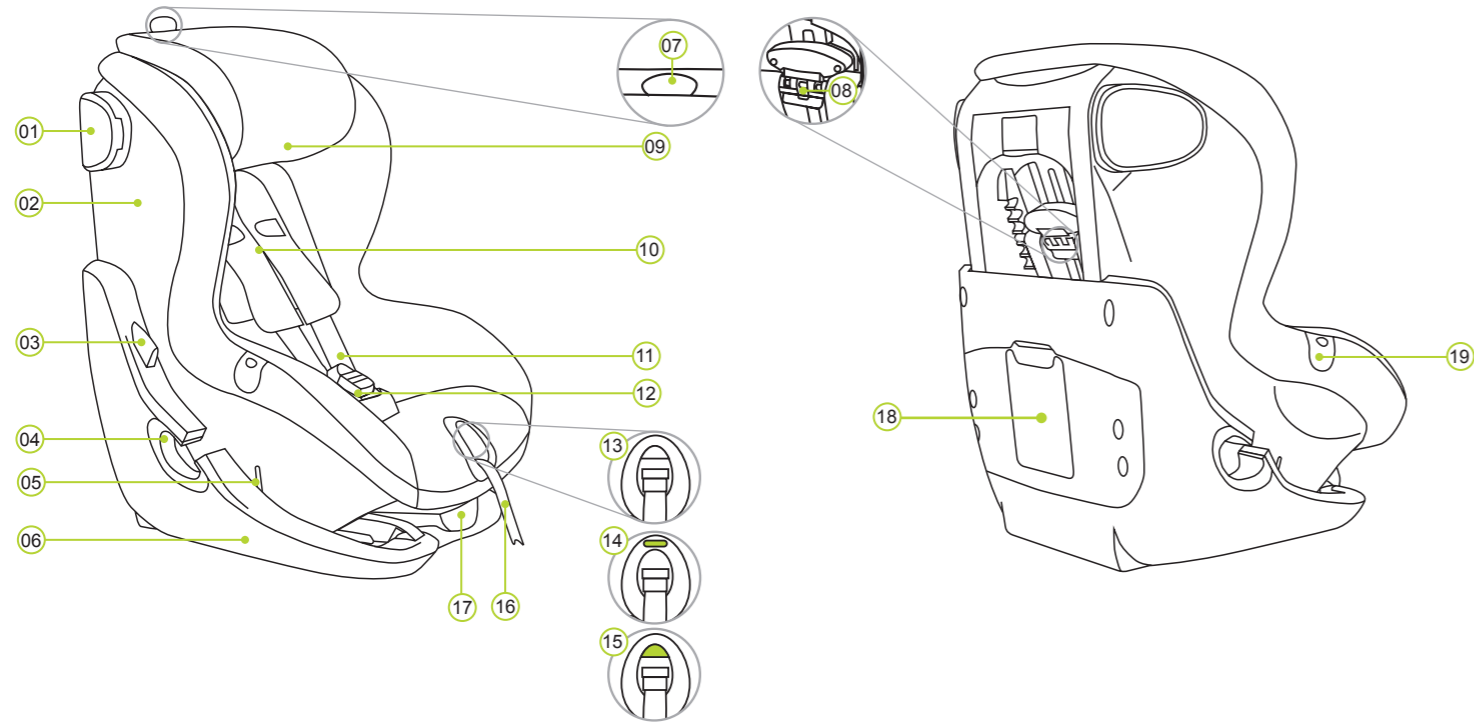

- 01 Upper belt guide
- 02 Seat shell
- 03 Release buttons
- 04 Lower belt guide
- 05 Adjustment lever
- 06 Seat base
- 07 Headrest adjuster (KING II ATS/LS)
- 08 Headrest adjuster (KING II)
- 09 Headrest
- 10 Shoulder pads
- 11 Shoulder straps
- 12 Harness buckle
- 13 Adjusting button
- 14 Indicator light (KING II LS)
- 15 Indicator light (KING II ATS)
- 16 Adjustment strap
- 17 Adjustment handle
- 18 User guide compartment
- 19 Harness retainer

### 4. CARE AND MAINTENANCE

#### Care for the harness buckle

It is vital for the safety of your child that the harness buckle works correctly. Malfunctions of the harness buckle are usually caused by accumulations of dirt or foreign bodies. Malfunctions include the following:

- The buckle latches are ejected only slowly when the red release button is pressed.
- The buckle latches will no longer lock home (i.e. they are ejected again if you try to push them in).
- The buckle latches engage without an audible "click".
- The buckle latches are difficult to insert (you feel resistance).
- The buckle only opens if extreme force is applied.

**Remedy:** wash out the harness buckle so that it functions properly once again.

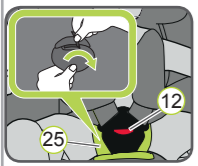

#### Cleaning the harness buckle

1. Open the harness buckle 12 (press the red button).
2. Adjust the seat shell 02 to the upright seating position.
3. Open the Velcro fastener on the crotch pad 25 and remove it and retain it.
4. Grasp below the seating area the metal plate 26 which keeps the buckle 12 at the seat base and turn it into a vertical position.
5. Slide the metal plate 26 through the slot 27.
6. Soak the harness buckle 12 in warm water with dishwashing liquid for at least an hour.
7. Rinse and dry the harness buckle 12 thoroughly.
8. Slide the metal plate 26 edgewise through the slot 27 in the cover and the seat base.
9. Rotate the metal plate 26 90°
- ⚠ DANGER!** Pull the harness buckle 12 firmly to ensure that it is securely fastened.
10. Insert the crotch pad 25 through the slot 27 and secure the Velcro fastener.

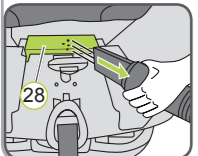
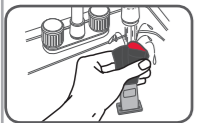
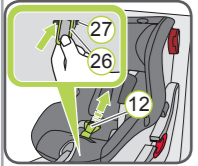

#### Cleaning the occupant sensor

1. Fold the lower part of the cover upwards.
2. Remove dirt and dust in the area of the occupant sensor 28 with a vacuum cleaner.
- ⚠ DANGER!** The occupant sensor 28 must not come in contact with water.

Please ensure that you only use the original BRITAX RÖMER replacement seat covers, as the seat cover is an integral part of the child safety seat and fulfils important functions to ensure the smooth operation of the system. Replacement seat covers are available from your dealer.

- The cover can be removed and washed using the delicates programme of the washing machine (30°C). Please observe the instructions on the washing label of the cover.
- The plastic parts can be cleaned with a damp cloth. Do not use any caustic cleaning agents (such as solvents).

**⚠ DANGER!** The child seat must not be used without the seat cover.



#### Removing the cover

Loosen the harness straps as far as possible.

1. Open the harness buckle 12 (press red button).
2. Remove the cover of the headrest 09.
3. Open the poppers 29 on the left and right side of the rear part of the cover.
4. Unhook the elastic seam of the cover under the edge of the seat shell.
- ⓘ TIP:** Start at the sides of the seat shell.
5. Pull the cover up and over the bezel of the strap adjuster.
6. Feed out the harness buckle 12 and the end of the strap from the cover.
7. Pull the cover upwards and remove it over the headrest 09.

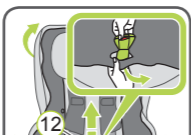
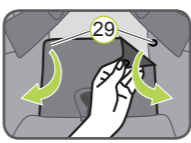

The cover can now be washed. Please observe the instructions on the washing label of the cover:



#### Re-fitting the cover

Proceed in reverse order to put on the cover.

### 2. INTRODUCTION

We are delighted that our KING II / ATS / LS can safely accompany your child through a new stage in its life.

**In order to protect your child correctly, the KING II / ATS / LS must always be used and installed as described in these instructions.**

If you have any further questions regarding its use, please feel free to contact us:

**BRITAX RÖMER**  
Kindersicherheit GmbH  
Blaubeurer Straße 71  
D-89077 Ulm  
Germany  
T: +49 (0) 731 9345-199  
F: +49 (0) 731 9345-210  
E: service.de@britax.com  
www.roemer.eu

**BRITAX EXCELSIOR LIMITED**  
1 Churchill Way West  
Andover  
Hampshire SP10 3UW  
United Kingdom  
T: +44 (0) 1264 333343  
F: +44 (0) 1264 334146  
E: service.uk@britax.com  
www.britax.eu

**These instructions use the following symbols stated below:**

Symbol	Keyword	Explanation
⚠	<b>DANGER!</b>	Risk of severe personal injury
⚠	<b>WARNING!</b>	Risk of minor personal injury
⚠	<b>CAUTION!</b>	Risk of material damage
ⓘ	<b>TIP:</b>	Useful notes

Instructions that follow a set sequence are numbered.

Example:

1. Press the button...

#### Belt guide colours

For better differentiation, the two vehicle seat belts are highlighted in different colours. The diagonal seat belt 21 in dark red and the lap belt 22 in bright red. The colour of the belt guides on the child safety seat follows the same colour scheme.

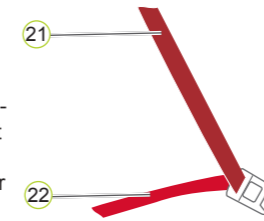

### 3. CERTIFICATION / USAGE

BRITAX RÖMER Child safety seat	Testing and certification In accordance with ECE* R 44/04 *ECE = European Standard for Child Safety Equipment	
	Group	Body weight
KING II / ATS / LS	I	9 to 18 kg

The child safety seat has been designed, tested and certified according to the requirements of the European Standard for Child Safety Equipment (ECE R 44/04). The seal of approval E (in a circle) and the approval number are located on the orange approval label (sticker on the child safety seat).

**⚠ DANGER!** This approval will be invalidated if you make any modifications to the child safety seat. Only the manufacturer is permitted to make modifications to the child safety seat.

**⚠ DANGER!** Never secure your child or the child safety seat with a 2-point belt. If you secure your child in the child seat with only a 2-point belt, then in the event of an accident this may cause serious injuries to your child, possibly resulting in death.

Please observe the instructions for using children's restraining systems in the operating instructions of your vehicle. The seat can only be used in vehicles with 3-point retractor safety-belts<sup>2)</sup>.

Please find the information on the seats approved for child safety seats of the weight classes 9 to 18 kg in the operating instructions of your vehicle.

**You can use your child safety seat as follows:**

In the direction of travel	yes
Against the direction of travel	no <sup>1)</sup>
with 2-point belt	no
with 3-point retractor safety belt <sup>2)</sup>	yes
on front passenger seat	yes <sup>3)</sup>
on outer rear seat	yes
on centre rear seat (with 3-point belt <sup>2)</sup> )	yes <sup>4)</sup>

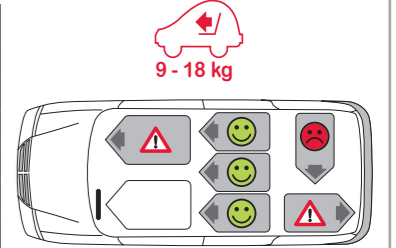

**1) Use is permitted on a rearward-facing vehicle seat (e.g. in a van or minibus) only if the vehicle seat is also approved for use by adults. The seat may not be in the area of effect of an airbag.**

**2) The seat is only compatible with 3-point retractor type safety-belts, approved to ECE Reg No. 16 or other equivalent standards.**

**3) If there is a front airbag: Slide the vehicle seat a long way back and refer to any instructions in vehicle owner's manual.**

**4) Cannot be used if the vehicle seat is equipped with only a 2-point belt.**

### 5. DISASSEMBLY AND DISPOSAL

#### UNFASTENING YOUR CHILD:

1. To unfasten your child, press the red release button of the 5-Point harness buckle 12.

#### REMOVAL:

1. Unbuckle the vehicle belt buckle 20 and loosen the harness straps.
2. Unhook the diagonal belt section 21 from the upper belt guide 01.
3. To open the shell: push one of the grey release buttons 03 and at the same time pull the seat shell 02 as far forward as possible.
4. Remove the diagonal 21 and the lap belt sections 22 from the light red lower belt guides 04.
5. Hold the seat shell 02 with one hand while pulling the grey adjustment lever 05 forward with the other hand.
6. To close the shell: tip the seat shell 02 against the seat base 06 over both engagement positions.
- ⚠ WARNING!** To avoid injuries take your hand away from the grey adjustment lever 05, as soon as getting over the two engagement positions.
7. Push the seat shell 02 with both hands against the seat base 06 until it is fully engaged.

#### DISPOSAL:

Please observe the waste disposal regulations in your country..

Disposal of packaging	Container for cardboard boxes
Seat cover	Residual waste, thermal utilisation
Plastic parts	According to the labelling in the corresponding container
Metal parts	Container for metals
Belt straps	Container for polyester
Buckle and tongue	Residual waste
Batteries	Container for batteries

9 kg - 18 kg

9 M ~ 4 Y



## KING II / ATS / LS

User instructions

GB

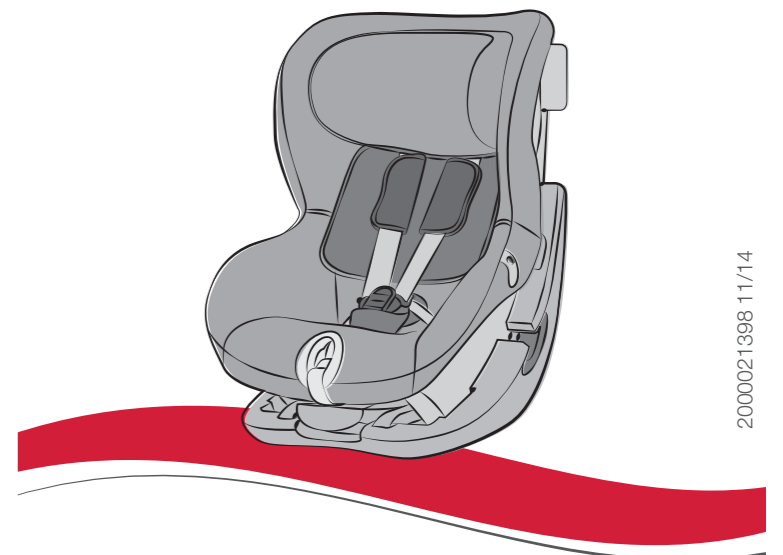

2000021398 11/14

www.britax.eu

## 6. SAFETY NOTES

**⚠ WARNING!** Please take the time to read these instructions carefully and keep them to hand in the intended storage compartment 18 on the child safety seat at all times! The instructions must be with the child safety seat if the latter is passed on to a third party.

**⚠ DANGER!** For the protection of your child:

- Use the KING II / ATS / LS exclusively for securing your child in your vehicle. It is in no way suitable as a seat or toy in the home.
- In the event of an accident with a collision speed of more than 10 km/h, the child safety seat may be damaged without the damage becoming immediately visible. In this case the child safety seat must be replaced. Please dispose of it properly.
- Have your child safety seat checked as a rule if it was damaged (e.g. if it falls to the ground).
- Regularly check all important parts for damage. Ensure that all mechanical parts, in particular, are fully functional.
- Never lubricate or oil parts of the child seat.
- Never leave your child unattended in the child seat in the vehicle.
- Let your child in and out of the vehicle from the pavement side as a rule.
- Protect the child safety seat against intensive direct sun radiation, as long as it is not in use. The child safety seat can become very hot under direct sun radiation. Child skin is sensitive and could thereby be injured.
- The more snugly the harness fits over your child's body, the better your child will be protected. Therefore avoid putting thick clothes on your child under the belt.
- Take regular breaks on long journeys in order to give your child the opportunity to play around when removed from the child seat.
- Use on the rear seat: Push the front seat forwards sufficiently so that the feet of your child cannot hit the backrest of the front seat (to avoid the risk of injury).

**⚠ DANGER!** For the protection of all vehicle occupants:

- In the case of an emergency stop or an accident, unsecured persons or objects may cause injury to other vehicle occupants. Please always check that...
- the backrests of the vehicle seats are locked (i.e. that a foldable rear seat bench latch is engaged).
  - all heavy or sharp-edged objects in the vehicle (e.g. on the parcel shelf) are secured.
  - all persons in the vehicle have their seatbelts fastened.
  - the child safety seat is always secured when it is in the vehicle, even if no child is being transported.

**⚠ WARNING!** For your protection when handling the child seat:

- Never use the child safety seat free-standing, not even for test sitting.
- When opening or closing, nothing must come between the seat shell 02 and the seat base 06. You or your child could pinch your fingers, injuring them.
- To avoid damage, ensure that the child safety seat is not jammed in between hard objects (car door, seat rails, etc.).
- Keep the child safety seat in a safe place if it is not in use. Do not place any heavy objects on the seat and do not store it directly next to sources of heat or in direct sunlight.

**⚠ CAUTION!** To protect your vehicle:

- Certain car seat covers made from more sensitive materials (e.g. velour, leather, etc.) may sustain signs of wear and tear when using child safety seats. For the optimum protection of your car seat covers, we recommend using the BRITAX RÖMER Car Seat Protector from our accessories programme.

**⚠ DANGER!** Batteries for the ATS product variant:

- The batteries must be replaced by an adult.
- Keep batteries out of the reach of children.
- Use only new batteries of the same type.
- Use only 2x AAA type, 1.5 volts batteries.
- Never use batteries that show signs of leakage.
- Remove the old batteries and dispose of them according to the disposal instructions on page I, chapter 5.
- Do not expose the batteries to excessive heat or fire, the batteries may burst or explode.
- Due to lower voltage do not use rechargeable batteries.
- Observe the warning on the packaging of your batteries.

## 7. ANGLE ADJUSTMENT

The seat shell of the KING II / ATS / LS can be put into four different angles:

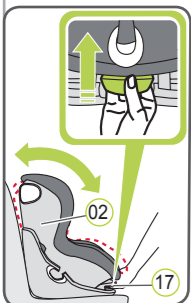

**To adjust the angle:**

Lift the adjustment handle 17 and pull/push the seat shell 02 into the desired position.

**⚠ DANGER!** The seat shell 02 must engage securely regardless of its position. Pull on the seat shell 02 to ensure that it is engaged properly.

**ⓘ TIP!** You can also adjust the angle of the seat shell 02 when your child is sitting in the child seat.

## 8. INSTALLATION OF THE CHILD SEAT

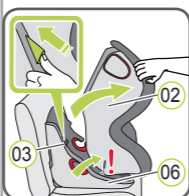

1. Place the child seat facing in the direction of travel on the vehicle seat.
2. Push one of the grey release buttons 03 and at the same time pull the seat shell 02 as far forward as possible.

**⚠ DANGER!** When opening or closing, nothing must come between the seat shell 02 and the seat base 06. You or your child could pinch your fingers, injuring them.

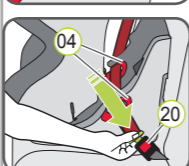
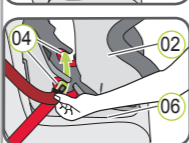

3. Pull out the vehicle seat belt and place it between seat shell 02 and seat base 06 through the two lower light red belt guides 04.

**⚠ DANGER!** Ensure that diagonal seat belt 21 and lap belt 22 lie in both lower light red belt guides 04 and both belts are not twisted.



4. Engage the buckle tongue in the vehicle seat buckle 20 with an audible "CLICK".



5. Tighten the diagonal belt section 21 by pulling the diagonal belt 21 strongly on the opposite side from the vehicle seat belt buckle.

6. Hold the seat shell 02 with one hand while pulling the grey adjustment lever 05 forward with the other hand. Tip the seat shell 02 against the seat base 06 over both engagement positions.

**⚠ WARNING!** To avoid injuries take your hand away from the grey adjustment lever 05, as soon as getting over the two engagement positions.



7. Push the seat shell 02 with both hands against the seat base 06 until it is fully engaged.

**⚠ DANGER!** The two red safety markings on the grey release buttons must not be visible.

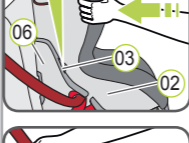

8. Place the diagonal belt section 21 in the upper dark red belt guide 01.

9. Give the child seat a firm pull forwards to ensure that it is securely fastened.

10. Observe the steps in the chapter 10.1 "ADJUSTING THE HEADREST".
11. Observe the steps in the chapter 10.2 "BUCKLE UP YOUR CHILD".

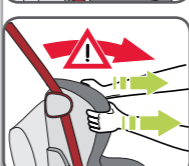

**⚠ For the safety of your child, before every journey in the car check that ...**

- ▶ the child safety seat is securely fastened,
- ▶ seat shell 02 and seat base 06 are fully engaged. The both red safety marks on the grey release buttons 03 must not be visible.
- ▶ the diagonal 21 and the lap seat belt sections 22 run on both sides through the light red lower belt guides 04,
- ▶ the diagonal seat belt section 21 runs through the upper dark red belt guide 01
- ▶ diagonal 21 and lap seat belt sections 22 are tight and **not** twisted,
- ▶ the vehicle seatbelt buckle 20 is **not** positioned between the lower light red belt guides 04 of the child seat.
- ▶ the headrest is adjusted correctly,
- ▶ the 5-point harness of your child seat are comfortable but FIRM fit around your child,
- ▶ the straps of the 5-point harness are **not** twisted,
- ▶ the buckle tongues 23 are engaged in the harness buckle 12.

**⚠ DANGER!** If your child tries to open the vehicle belt buckle 20, or the 5-point harness buckle 12 stop immediately as soon as safely possible. Check whether the child safety seat is correctly fastened and ensure that your child is correctly secured. Explain to your child the dangers associated with their actions.

**UNFASTENING YOUR CHILD AND REMOVAL:**

To unfasten your child or to remove the child safety seat, observe the steps in Section 5 "DISASSEMBLY AND DISPOSAL" [PAGE I]

## 9. 1 ADJUSTING THE HEADREST

It is important to set the headrest 09 height position correctly for optimal 5-point harness operation and ensure the safety of your child.



The headrest 09 must be adjusted so that the top of the harness shoulder pads are in-line with your child's shoulders.

If your child is wearing thick clothing you may need to raise the headrest again to ensure correct positioning of the harness.

To adjust the height of the headrest to fit your child:

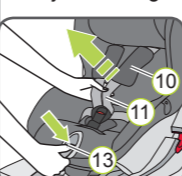

## 1. Loosening the harness

Press the adjustment button 13 and at the same time pull below the shoulder pads 10 both shoulder straps 11 forward.

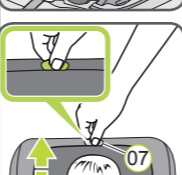

## 2. Adjusting the headrest for:

## KING II ATS / LS

1. Sit your child in the seat and check the height of the headrest 09.
2. Pull / push the headrest adjuster 07 to move the headrest up or down.
3. Repeat the procedure until the headrest 09 is at the correct height.

**⚠ WARNING!** If the headrest is positioned too low it can seriously compromise the effectiveness of the harness, and indicator systems.

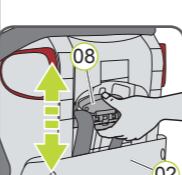

## KING II

1. Pull the lever of the headrest adjuster 08 at the rear of the seat shell 02. Now the headrest is unlocked.
2. Slide the unlocked headrest adjuster 09 into the desired direction to the correct height. As soon as you release the lever of the headrest adjuster 08, the headrest 09 engages.
3. Sit your child in the seat and check the height of the headrest 09. Repeat the procedure until the headrest 09 is at the correct height.

## 9.2 BUCKLE UP YOUR CHILD

The more snugly the harness fits over your child's body, the better your child will be protected. Therefore avoid putting thick clothes on your child under the belt.

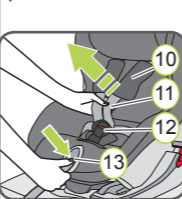

1. Open the harness buckle 12 (press red button)
2. Press the adjusting button 13 and at the same time pull below the shoulder pads 11 both shoulder straps 10 forward.
3. Insert the buckle tongues 23 into the harness retainers 19.
4. Sit your child down in the seat.
5. Check the correct height of the headrest and adjust it if necessary [see above].
6. Make sure that your child's back lies flat against the backrest of the child seat.
7. Unhook the buckle tongues 23 from the harness retainers 19.
8. Guide the two buckle latches 23 together and engage them before putting them into the harness buckle 12 - this should make an audible click.

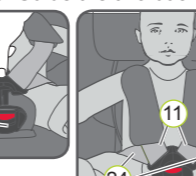
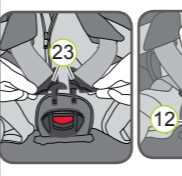

9. Pull shoulder straps 11 to remove all slack from the lap section ensuring the harness lies flat and has a snug fit.

**⚠ DANGER!** The lap belts 24 must be positioned as low as possible over your child's hips.

10. Carry out the steps in section "9.3 SECURING YOUR CHILD" for your particular product variant.

## 9.3 SECURING YOUR CHILD

**Product variant KING II:**



**⚠ WARNING!** Pull out the adjusting strap 16 straight forward.

1. Pull on the adjusting strap 16 until the harness lies flat and is close against your child's body.
2. Observe the safety notes in the chapter "8. INSTALLATION OF THE CHILD SEAT"

**Product variant KING II LS:**

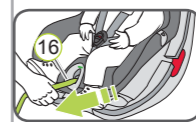

**⚠ WARNING!** Pull the adjuster strap 16 straight forward (not upwards or downwards).

1. Pull the adjuster strap 16 until the indicator light 14 illuminates "green" and you can hear an audible "Click" which indicates that the harness is tightened correctly.

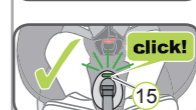

**ⓘ TIP!** The green indicator light turns off automatically after a few seconds.

2. Observe the safety notes in the chapter "8. INSTALLATION OF THE CHILD SEAT"

**What to do when the indicator light does not illuminate "green" ...**

- Check if the headrest is adjusted correctly according to the chapter "9.1 ADJUSTING THE HEADREST".
- Ensure that you have pulled the adjuster strap with enough force.
- In general the battery in the product is a non replaceable item and must not be changed due to its long life.
- If the problem can not be resolved using the above methods, contact your service representative or the BRITAX RÖMER Customer Service.

**Product variant KING II ATS:**

Your child seat is equipped with a system that automatically keeps the tension within a defined working range in the harness once adjusted correctly and also with indicator and alert functions. The system works with an occupant sensor, so without your child sitting in the seat the indicator light will be off.

**⚠ DANGER!** The automatic harness tensioning system and indicator and alert functions operate within limits and subject to correct usage. They provide assistance only and do not replace safety checks, recommendations or requirements or negate responsibility for them. You must always take full responsibility for and periodically check the safety of your child.



**⚠ WARNING!** Pull the adjuster strap 16 straight forward (not upwards or downwards)

1. Pull the adjuster strap 16 until the indicator light 15 illuminates "green" and you can hear an audible sound.

▶ The belt tensioning of your child seat is now active and removes excess belt length automatically within a defined working range.

**ⓘ TIP!** The green indicator light 15 turns off automatically after a few seconds, but the system continues to work. It is possible at any time to repeat step 1.

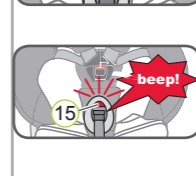

**⚠ DANGER!** When the indicator light 15 illuminates red your child is not properly secured or the automatic retraction system has reached its limit. Stop at the next safe opportunity and repeat the steps of the chapter "9.3 Securing your child".

**ⓘ TIP!** If your child is still fastened, the alert can be a warning that the automatic retraction system is at the end of its working range. You may still have a fit well beyond your first installation but the automatic adjustment has stopped. You may either complete your journey (with periodic checks on your child) or pull over at the next convenient place and simply pull the adjuster strap again (without unbuckling) to green to reload your automatic retraction system, this will also reset your alert system.

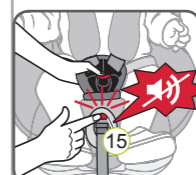

**ⓘ TIP!** You can remove your sleeping child by pressing and holding the mute button first whilst undoing the buckle.

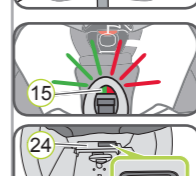

**⚠ DANGER!** When the indicator light 15 flashes red and green the batteries must be replaced.

Lift the seat cover and the foam cushion on the seating surface and change the two type AAA batteries in the battery compartment 24.

**What to do when the indicator light does not illuminate at all...**

- Check if the headrest is adjusted correctly according to the chapter "9.1 ADJUSTING THE HEADREST".
- Check if there is any accumulation of dirt or foreign objects on the seating area under the occupant sensor. If necessary clean the area as described in chapter 4 [page I].
- Replace both batteries
- Ensure that you have pulled the adjuster strap with enough force.
- If the problem can not be resolved using the above methods, contact your service representative or the BRITAX RÖMER customer service.