

COSATTO

baby stuff with personality

elle

cuddly, protective, intuitive...

power-dressing
protector

HUG

CAR
SEAT

NITTY
GRITTY

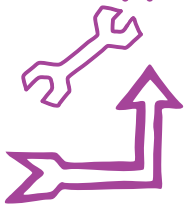

...www.cosatto.com

Cosatto Ltd, Bentinck Mill, Bentinck Street, Farnworth, Bolton, BL4 7EP, England
Tel: +44(0)871 977 3900 Fax: +44(0)871 977 3910 Email: enquiry@cosatto.com



IMPORTANT: RETAIN FOR FUTURE REFERENCE. READ CAREFULLY. YOUR CHILD'S SAFETY MAY BE AFFECTED IF YOU DO NOT FOLLOW THESE INSTRUCTIONS

user guide

Thank you for choosing a Cosatto product. Please take a little time to read the important safety notes detailed below. This will ensure many years of happy, safe use.

The instruction manual should be kept safely with child car seat for its life period: There is a slot at the rear of the child car seat for storage of the instruction manual.

safety: take note

WARNING: A CHILDS SAFETY IS YOUR RESPONSIBILITY

- This child car seat has been approved for mass group 1, 2 & 3 which is suitable for transportation in cars of children from 9kg (approximately 9 months old) up to 36 kg (approximately 11 years old).
- **WARNING:** After an accident the child car seat should be replaced.
- **WARNING: NEVER** use this child car seat on side facing vehicle seat.
- **WARNING: NEVER** use this child car seat on passenger seat fitted with active airbag.
- **WARNING: NEVER** leave your child unattended, even for the shortest time.
- **WARNING: ALWAYS** secure your child with the safety harness when using this child car seat.
- **WARNING: DO NOT** attempt to dismantle, modify or add to any part of the child car seat or change the way your vehicle seat belts are made or used.
- **WARNING:** Any rigid items and plastic parts of the child car seat must be so located and installed that they are not liable, during everyday use of the vehicle, to become trapped by a movable seat or in a door of vehicle.
- **WARNING:** If any load bearing points other than those described in the instructions are used, this can significantly reduce the protection factor of the child car seat.
- **WARNING: DO NOT** use the child car seat in the home. It has not been designed for home use and should only be used in your car.

- The child car seat must always be placed in a forward facing position.
- Always make sure that the child car seat harness and vehicle belt are correctly tensioned to ensure maximum protection for your child.
- The buckle has been designed to be released quickly in an emergency. **IT IS NOT CHILD PROOF.** More inquisitive children might learn to undo the buckle. Children should be told never to play with it or any other part of the child car seat.
- Never use replacement parts other than those approved by Cosatto.
- In Group 2 & 3 modes, the lap belt must be worn in such a way as to properly secure the pelvis of the child.
- Never use the child car seat without its fabric cover because the seat cover constitutes as an integral part of the child car seat performance. The seat cover should not be replaced with any other than the ones recommended by Cosatto.
- Safely secure any luggage and other objects that might cause injury to the occupant of the child car seat in the event of a crash.
- After an accident, replace your child car seat and the vehicle seat belts. Although they may look undamaged, they may not protect your child as well as they should.
- Cosatto advise that child car seats should not be brought or sold second-hand. Many seats sold through local advertising and car-boot sales have been found to be dangerous.
- Prevent harness/vehicle belt from getting trapped between car doors or rubbing against sharp parts of the seat or body.
- If the harness/vehicle belts becomes cut or frayed, replace it before travelling.
- If the vehicle has been left in the sun for a long time, check the seat cover and make sure it is not too hot before placing the child in the child car seat.
- Security is only guaranteed if the child car seat is fitted in accordance with these instructions.
- Failure to comply with the above instructions will automatically void the warranty and exempt Cosatto from any liability.

storage of instruction manual

The instruction manual should be kept safely with child car seat for its life period: There is a slot at the rear of the child car seat for storage of the instruction manual.

notice:

- 1 This is a "Universal" child restraint .It is approved to Regulation No.44,04 series of amendments, for general use in vehicles and it will fit most, but not all, car seats.
- 2 A correct fit is likely if the vehicle manufacturer has declared in the vehicle handbook that the vehicle is capable of accepting a "Universal" child restraint for this age group.
- 3 This child restraint has been classified as "Universal" under more stringent conditions

as those which applied to earlier designs which do not carry this notice.

- 4 This child restraint is only suitable if the vehicle is fitted with a type approved lap/3 point/static/with retractor safety belt, in compliance with standard UN / ECE Regulation No.16 or other equivalent standards.
- 5 If in doubt, consult either the child restraint manufacturer or retailer.

operation:

1 - getting to know your child car seat

- | | | |
|---------------------|----------------------------|----------------------------------|
| 1. Headrest | 6. Crotch pad | 11. Lower shaft |
| 2. Upper seat liner | 7. Harness adjuster flap | 12. Pocket for instructions |
| 3. Chest pads | 8. Harness adjuster strap | 13. Side impact protection block |
| 4. Lower seat liner | 9. Headrest adjuster lever | |
| 5. Harness | 10. Upper shaft | |

2 - approved seatbelt requirement

WARNING: Your child car seat can only be installed forward facing using a three point lap and diagonal belt in the front or rear passenger seats of the car.

3 - adjusting the harness

The shoulder harness must fit at the top of your child's shoulders. The height of the shoulder harness can be raised or lowered by adjusting the height of the headrest. Squeeze the lever at the back of the headrest and raise or lower the headrest to the correct position (a).

The headrest can be set at five different heights in group 1 mode with the chest pad locking bar in place. There are four additional positions in Group 2 & 3 mode once the chest pad locking bar has been removed.

You can use the harness with your child as long as the shoulder harness fit your child's shoulder correctly.

To loosen the harness, push the adjuster button (b) in as you pull the shoulder harness forward as much as possible (c).

Important: Pull the harness **UNDER** the chest pads. **DO NOT** pull on the chest pads. To tighten the harness pull the adjustment strap forward (d).

4 - adjusting the seat angle

The child car seat can be used in five different positions. To adjust the recline angle of the seat pull the lever at the front of the seat (a) then move the seat (b). Release the handle in the required position and push until you hear a distinct click.

5 - installation of the car seat 9 to 18kg (group 1 - approx. 9 months to 4 years old) - part 1

Place the child car seat on the vehicle seat.

6 - installation of the car seat 9 to 18kg (group 1 - approx. 9 months to 4 years old) - part 2

Adjust the child car seat to the most reclined position (a). See step 4.

Remove both shafts by releasing the end from its lock (b) and pulling the shafts out of the seat (c). Pull the seat forward to gain access to the rear of the seat (d).

Open the lower belt clip by lifting the retaining rod with your finger (f) and pulling the belt lock back.

Press down on the tab to open the shoulder belt clip (g).

7 - installation of the car seat 9 to 18kg (group 1 - approx. 9 months to 4 years old) - part 3

Install the vehicle seat belt ensuring that the lap belt fits into the clips at the base of the car seat (a) and the shoulder belt fits into the shoulder belt clip (b) nearest the the vehicle seat belt buckle.

Fasten the vehicle seat belt (c).

Pull the shoulder belt (d) to remove the slack from the belt.

Press down on the shoulder belt clip (e) and close the tab to lock the shoulder belt in place.

Press down on the lower belt clip (f) until it locks in place. Ensure the retaining rod is correctly located (g).

8 - installation of the car seat 9 to 18kg (group 1 - approx. 9 months to 4 years old) - part 4

Lift the vehicle seat belt (a) and push the upper shaft back into position (d) and under the belt.

Push the upper shaft into the clip (c) to lock it in position.

Close the child car seat and push the lower shaft into position (d) and lock it in place (c).

Note: The upper and lower shaft can be fitted from either side of the child car seat.

Important: The vehicle seat belt **MUST** fit over the upper shaft (e).

9 - seating your child into the car seat harness

Loosen the harness by pushing the adjuster button (a) in as you pull the shoulder straps (b) forward as much as possible.

Important: Pull the harness **UNDER** the chest pads. **DO NOT** pull on the chest pads.

Unfasten the harness buckle by pressing the red button (c) and releasing the clips (d) and open out the belts (e).

Place your child in the child car seat.

Fit the harness around your child and fasten the harness buckle by joining the clips (f) and pushing them both into the buckle (g).

Check that the harness is not twisted and pull the harness up (h) to tighten the lap

sections which is designed to fit low down on your child's body.

Pull the adjuster strap forward (i) making sure the harness is a comfortable but FIRM fit around your child.

Finally, pull both chest pads down (j) from your child's shoulders onto their chest.

Note: The chest pads are an important safety feature. Never use the child car seat without them.

10 - removing the harness and seat liners - part 1

Open the seat to gain access to the rear. See step 5.

Loosen the harness. See step 3.

At the rear of the seat remove the shoulder harness from the harness connector (a).

Lift the shoulder harness to gain better access to the chest pad locking bar.

Release the chest pad locking bar on the rear of the seat (b) by pulling it backwards sharply.

Slide the chest pad straps off the chest pad locking bar (c).

Pull the shoulder harness from the front of the child car seat (d) until the shoulder harness and chest pad straps come through the backrest of the seat (e).

11 - removing the harness and seat liners - part 2

Lift the bottom part of the seat cover to gain access to the waist harness clips.

Push the waist harness clip ends through the slots in the child car seat (a), push the clips through from under the seat (b) and then through the seat cover.

Push the crotch harness clip through the slot in the underside of the seat (c) and then through the seat cover and seat liner.

The seat liners can now be removed from the child car seat (d).

12 - removing the harness and seat liners - part 3

Pull the harness adjuster connector (a) until the end of the harness adjuster strap fits under the harness adjuster flap (b).

Open the lower belt clip (c). Push the harness connector through the hole in the lower belt clip (d) then wrap the adjuster strap around the lower belt clip retaining rod (e).

Place the harness connector under the lower belt clip (f).

Close the lower belt connector taking care not to trap the harness adjuster strap or connector.

Close the seat and refit the upper and lower locking bars.

13 - installing the child car seat 15 to 36kg (group 2 & 3 approx. 4 to 11 years old) - part 1

Before installation, remove the harness and seat liners from the child car seat (See steps 9 & 10) and lock the back of the seat with the upper and lower shafts (See step 7).

Note: The harness, chest pads, crotch pad & chest pad locking bar should be stored away safely for future use. The chest pad locking bar MUST NOT be used in group 2 & 3 installations.

Release the vehicle seat belt lock (a) under the headrest. Feed the vehicle seat belt into the gap (b) under the vehicle seat belt slot until the vehicle seat belt is located in the vehicle seat belt slot. Push the vehicle seat belt lock back (c).

14 - installing the child car seat 15 to 36kg (group 2 & 3 approx. 4 to 11 years old) - part 2

Place your child in the child car seat and fasten the vehicle seat belt.

Pull the vehicle seat belt upwards to tension the belt (a).

The vehicle seat belt should be positioned between your child's shoulder and neck (b).

If the vehicle seat belt is in the correct position the lap belt should fit over the red tags sewn into the cover on either side of the seat (c). The height of the vehicle seatbelt can be adjusted by squeezing the lever at the back of the headrest and raising or lowering the headrest to the correct position (d).

For the safety of the child please check:

- The diagonal belt section runs through the seat belt guide located on the headrest and the lap belt must pass over the red tags sewn into the seat cover.
- The straps are tightened and not twisted.
- The vehicle seat belt buckle is correctly located on the side of the car seat and is not obstructed.

Always make sure that your vehicle seat belts are correctly tensioned to ensure maximum protection for your child.

Anchorage Group 2 and 3

The shoulder belt must cling to the child's shoulder and chest. The lap belt must pass over the red tags sewn into the seat cover.

When anchoring the child car seat, make sure the vehicle seat belt is not twisted, in addition, the vehicle seat belt must be appropriately tensioned and placed around the child's body to ensure that the child car seat is properly anchored. Always make sure that your vehicle seat belts are correctly tensioned to ensure maximum protection for your child.

15 - removing the covers for cleaning

Remove the harness and seat liners if fitted (See steps 9 & 10).

Headrest: Lift the headrest to the highest position (a). Starting on one side carefully pull the cover off (b).

Release the belt lock under the headrest (c) and pull the elastic loop through the gap (d).

Release the elastic loop (e). Repeat this procedure on the other side of the headrest and remove the headrest cover.

Seat: Starting on one side carefully pull the cover off the seat (f). At the rear of the backrest lift the elastic strap over the headrest (g). Push the harness adjuster strap through the elastic loop under the harness adjuster flap (h) then pull the cover from around the adjuster button (i). Unclip the six elastic loops holding the cover to the seat (j) and remove the cover.

Side impact protection block cover: Carefully pull the cover off (k).

IMPORTANT: The covers are a safety feature. NEVER use the child car seat without them.

16 - refitting the seat cover

Ensure the sponge pad is placed on the seat (a).

Fit the side impact protection block covers by stretching the cover over the impact pads (b).

Place the cover on the seat.

Fit the elastic strap over the headrest (c).

Fit the six elastic loops on the inside of cover to the mounting points on the seat (d). Fit the cover around the adjuster button (e) then push the harness adjuster strap through the elastic loop under the harness adjuster flap (f).

Stretch the cover over the seat and backrest (g) ensuring the elastic edging tucks inside the seat structure and secures the cover to the seat.

17 - refitting the headrest cover

Fit the elastic loop (a) through the slot in the vehicle seat belt lock.

Fit the elastic loop under the vehicle seat belt lock (b).

Close the vehicle seat belt lock (c).

Stretch the cover over the headrest (d) ensuring the elastic edging tucks inside the headrest structure and secures the cover to the headrest.

18 - refitting the harness for group 1 use - part 1

If required, release the harness adjuster strap. Open the seat to gain access to the rear. See step 5.

Open the lower belt clip (a) and unwrap the harness adjuster strap from the lower belt clip retaining rod (b). Push the harness connector through the hole in the lower belt clip (c) then from the front of the child car seat pull the harness adjuster strap out from under the harness adjuster flap (d).

Close the lower belt clip. Close the seat and refit the upper and lower locking bars.

19 - refitting the harness for group 1 use - part 2

Release the harness from the restraint system if required.

Feed the crotch harness through the slot in the seat liner and seat cover (a). Push the crotch harness clip through the slot in the seat (b). Flatten the clip to secure.

Fit the waist harness clips through the slots in the seat cover and seat (c). Push the clips

through the seat and back up from underneath (d). Flatten the clips to secure. Loosening the cover around the waist harness mounting points will help with access.

20 - refitting the harness for group 1 use - part 3

Feed the shoulder harness through the chest pads then push the straps through the slots in the upper seat liner and backrest (a).

Slide the chest pad straps onto the chest pad belt locking bar at the rear of the backrest (b). Push the chest pad locking bar into the backrest until it's locked in place (c).

Fit the ends of the shoulder harness to the harness connector (d).

care

Your child car seat has been designed to meet safety standards and with correct use and maintenance will give many years of trouble free performance.

Storing a damp child car seat will encourage mildew to form.

After exposure to damp conditions, dry off with a soft cloth and allow to dry thoroughly before storing.

Store your child car seat in a dry, safe place.

Do not leave the child car seat in sunlight for prolonged periods - some fabrics may fade.

maintenance

This child car seat requires regular maintenance by the user.

DO NOT take apart, or attempt to take apart, any of the harness when cleaning the harness and seat. It is unnecessary and dangerous to do so.

Food and drink may find their way inside the buckle of the harness. This can stop it working properly.

Clean the harness buckle with mild hand soap and water. Rinse thoroughly with warm water. Latch and unlatch the tongues of the buckle several times until a strong click is heard. If you cannot hear a strong click run it under warm water to rinse again.

If the harness/ vehicle belts becomes cut or frayed, replace it before travelling.

cleaning

The harness may be cleaned by sponging lightly using warm water and a mild detergent.

Plastic and metal parts may be sponged clean with warm water and a mild detergent.

Never clean with abrasive, ammonia based, bleach based or spirit type cleaners.

Cleaning the covers:

Please read the labels on the covers for washing instructions.

The seat covers can be removed easily for washing.

The seat covers can be machine-washed with a mild detergent, at 30°C.

Don't wring, spin, or iron the seat covers.

Clean plastic shell of the child car seat by wiping it with a damp cloth.

replacement parts

The replacement parts shown below are available for your product. In the event that you require any of these parts, please contact your local distributor. For the contact information for your local distributor please refer to <http://www.cosatto.com/stockists>

If you are a UK or Ireland customer, please contact us at spares@cosatto.com

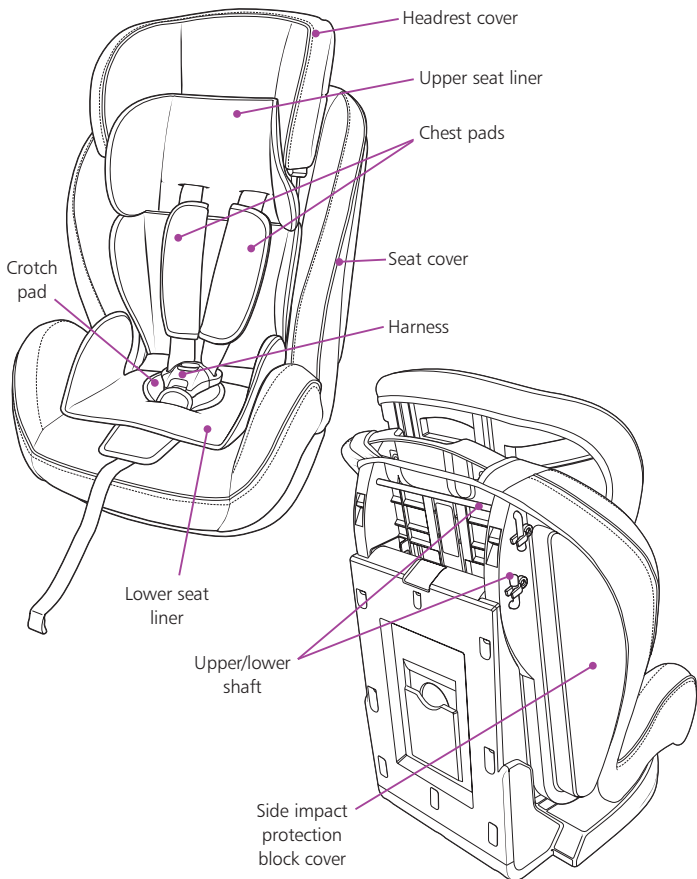

1

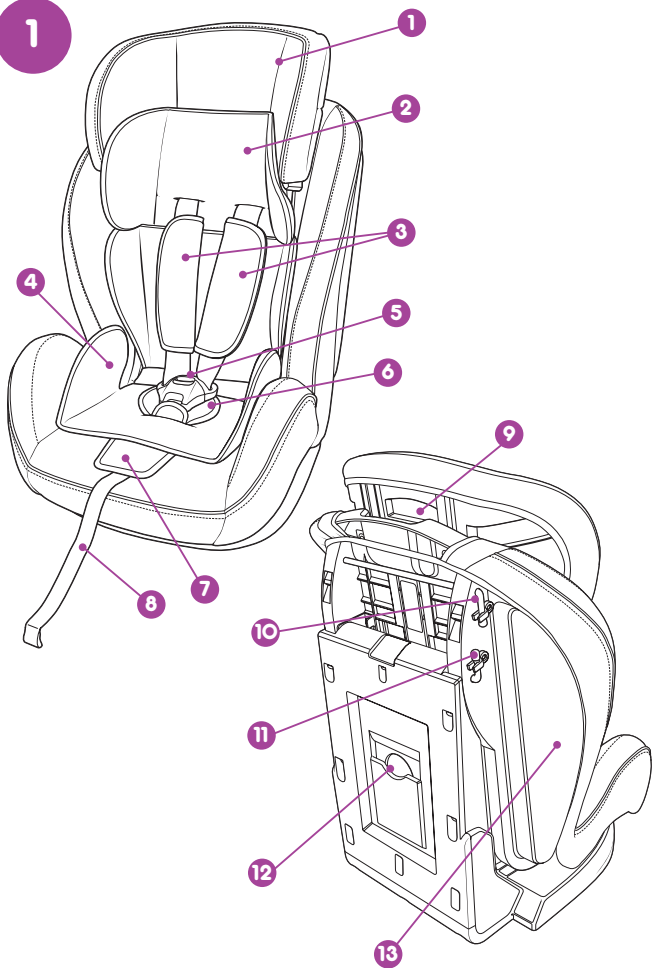

2

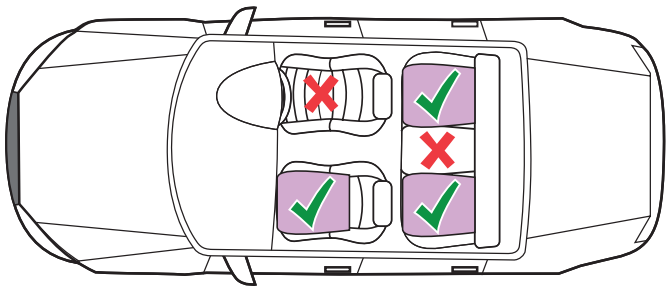
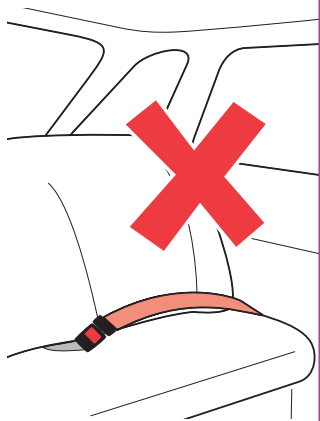
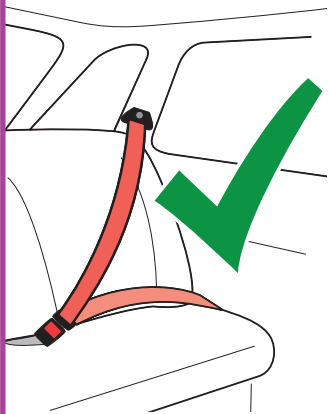

3

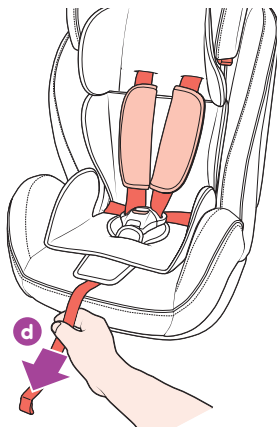
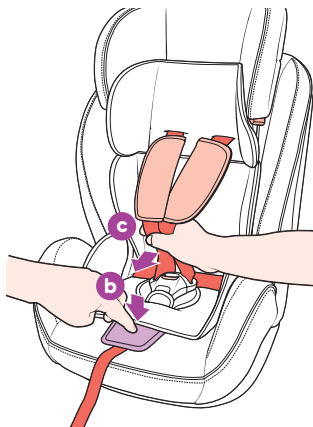
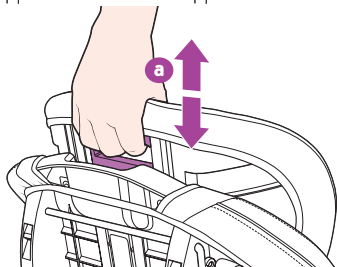
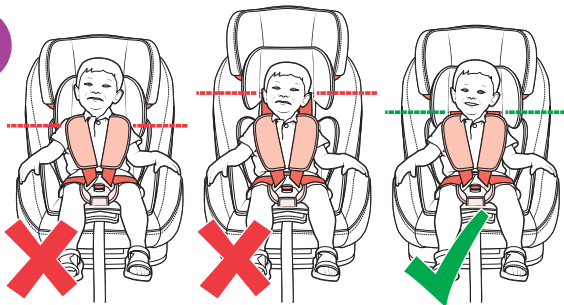

4

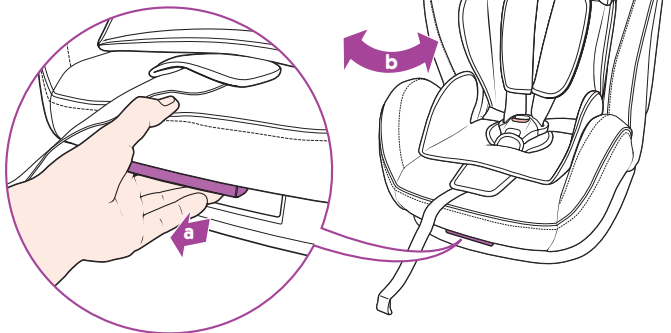

5

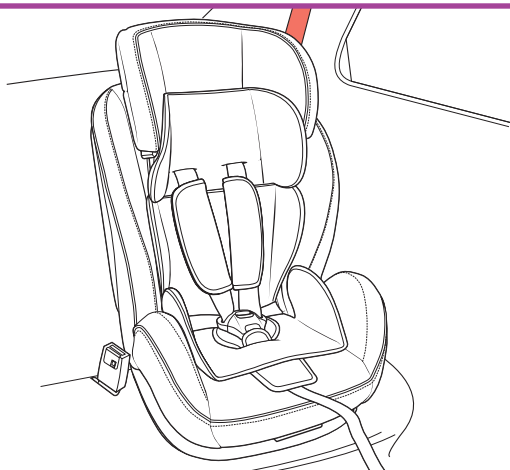

6

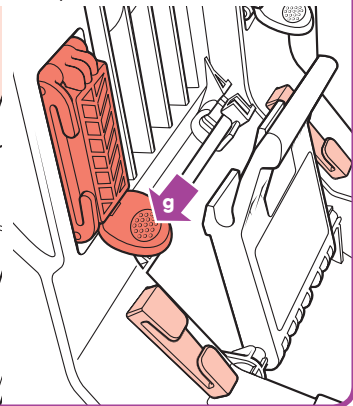
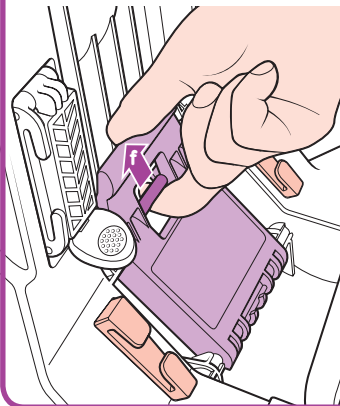
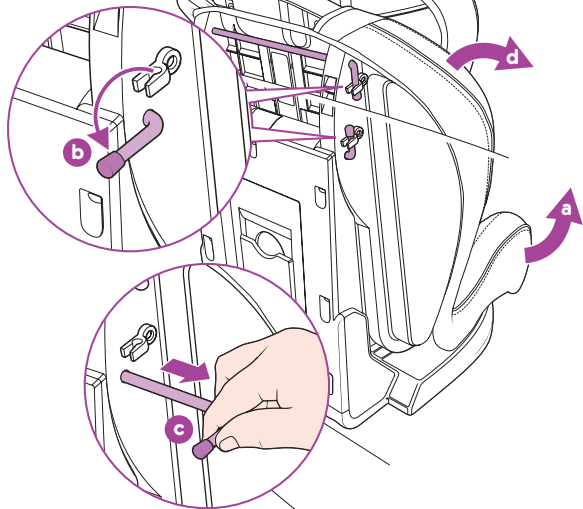

7

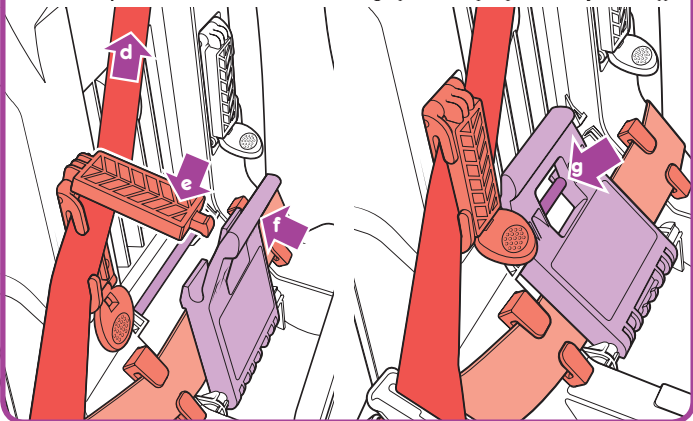
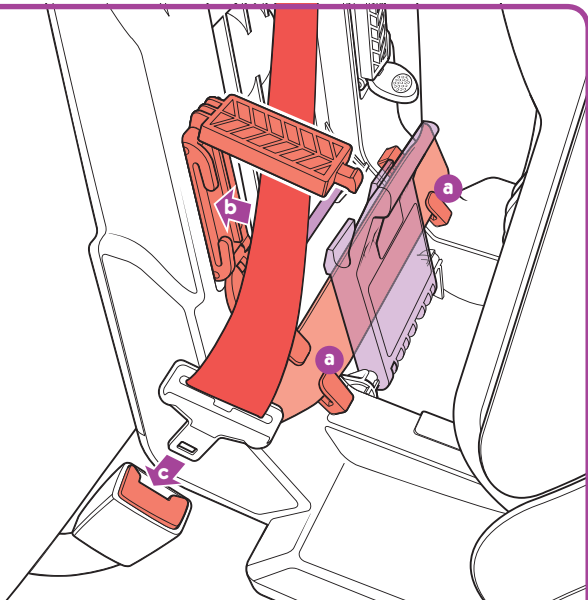

8

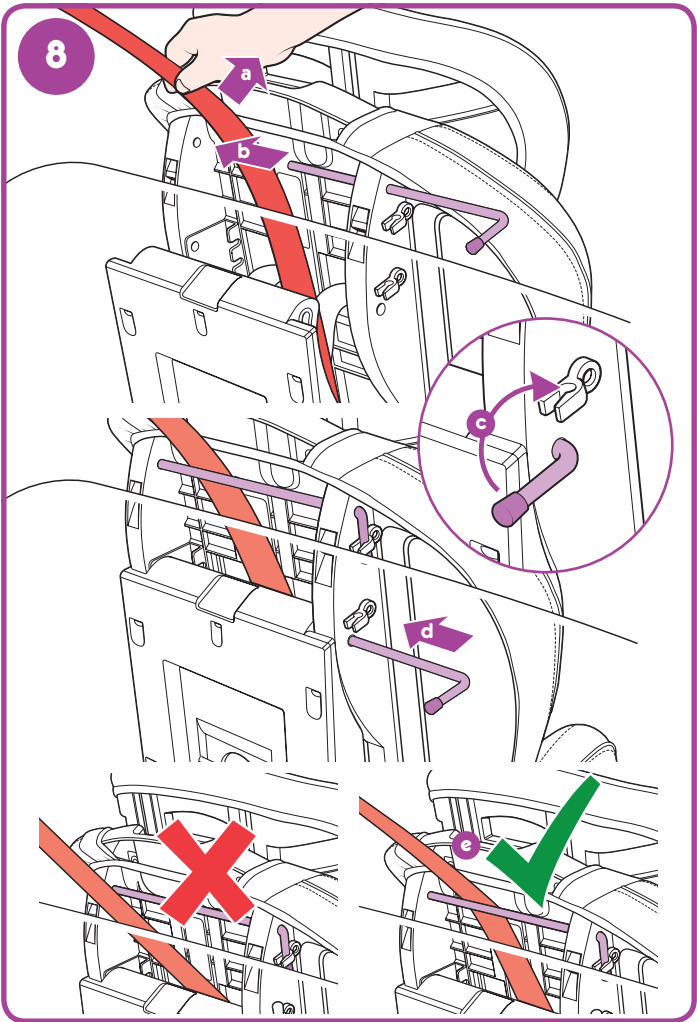

9

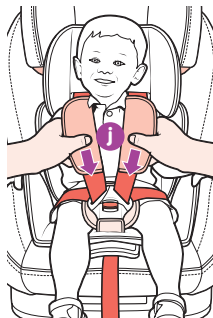
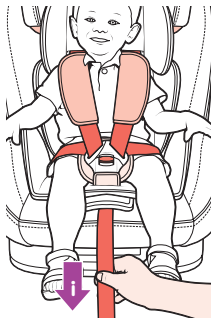
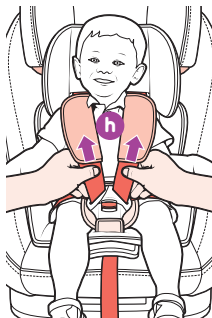
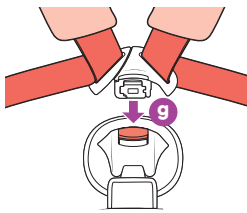
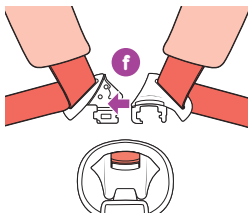
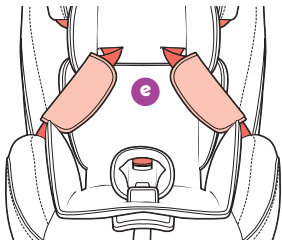
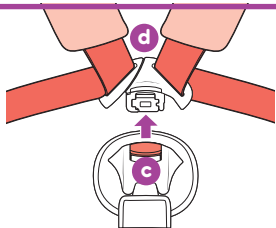
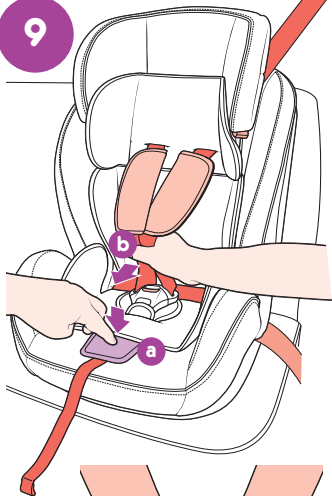

10

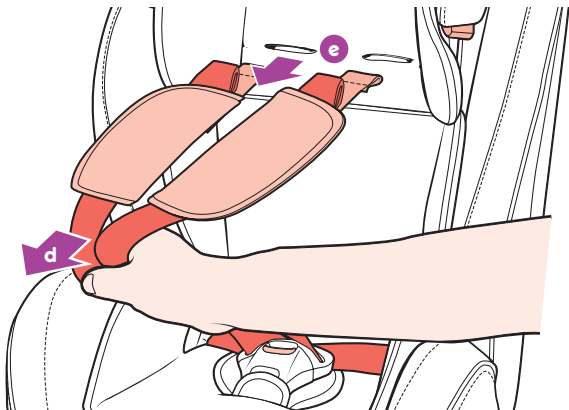
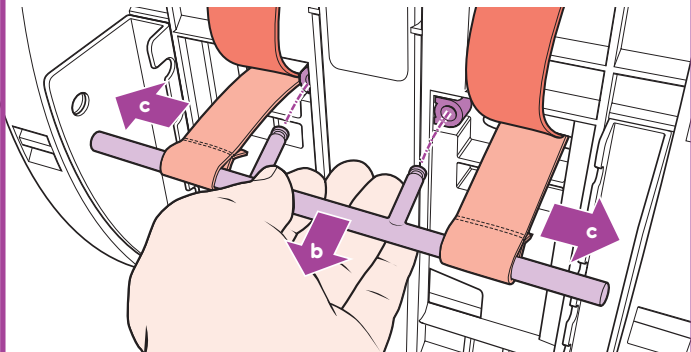
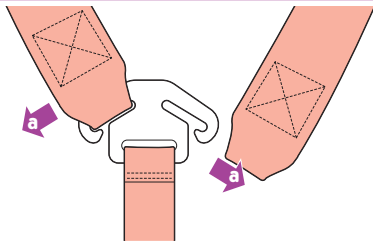

11

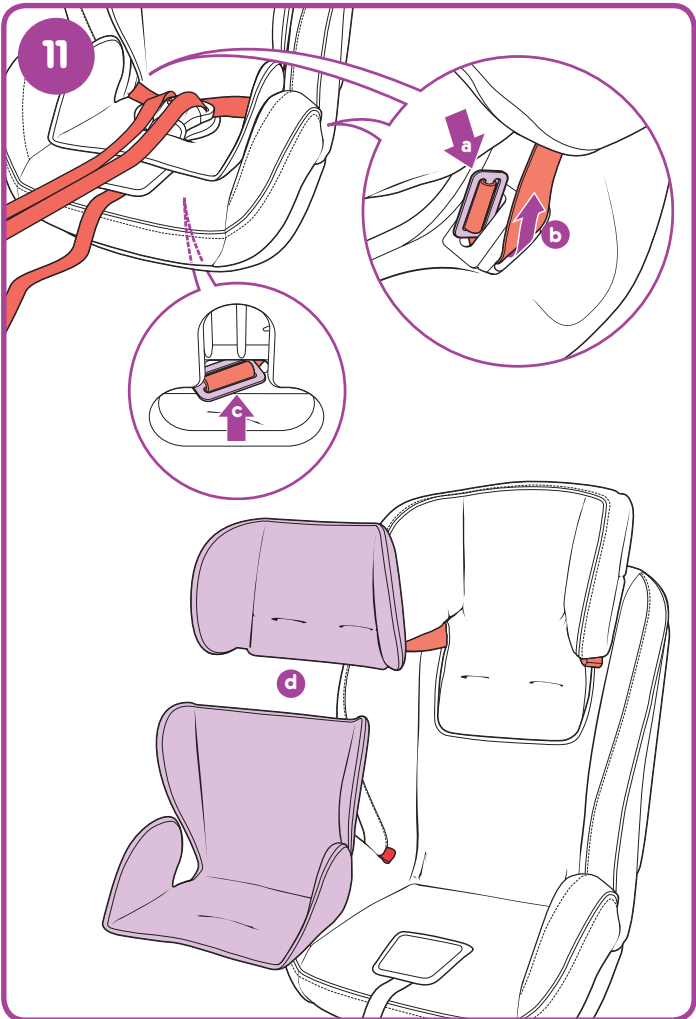

12

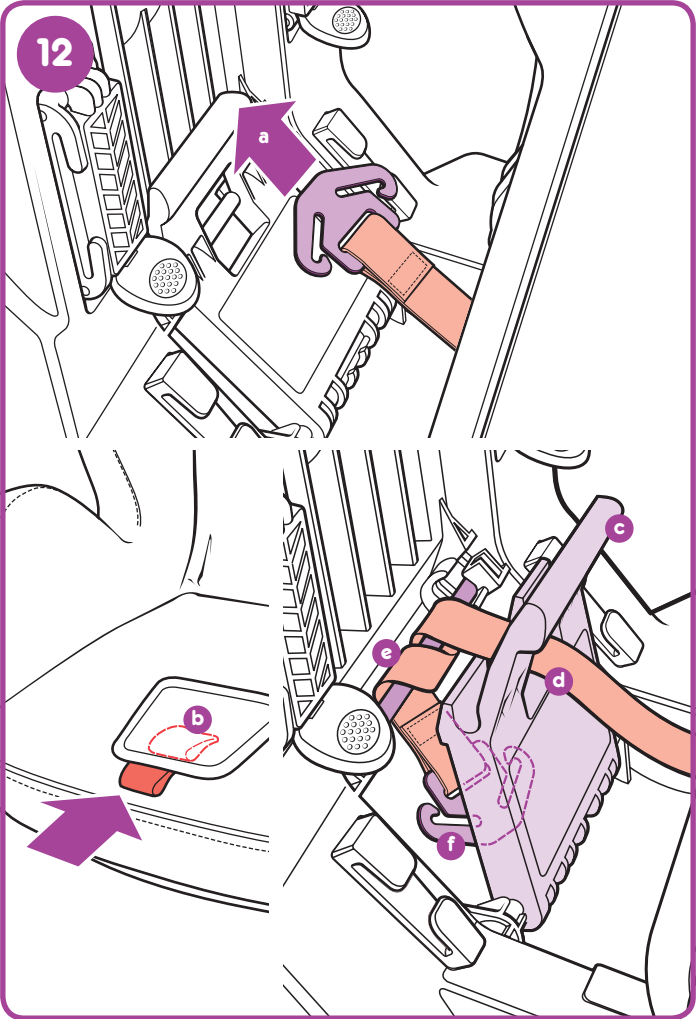

13

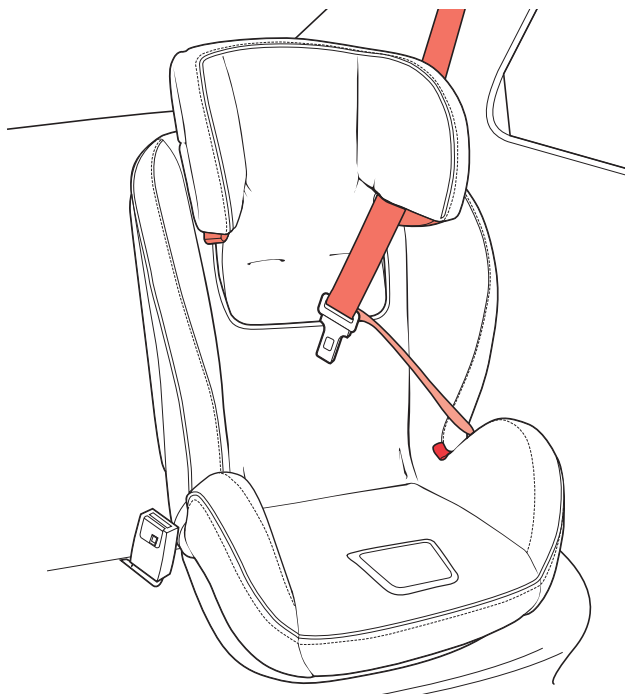
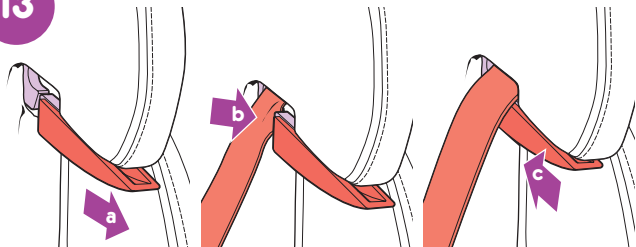

14

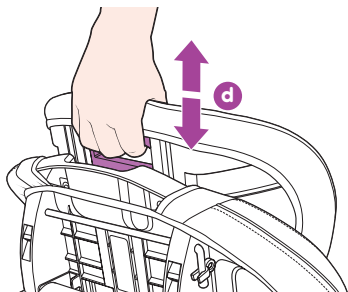
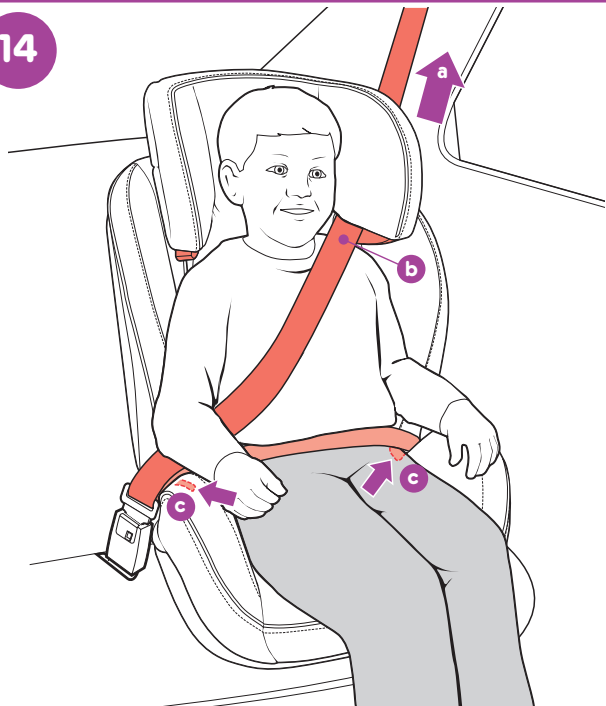

15

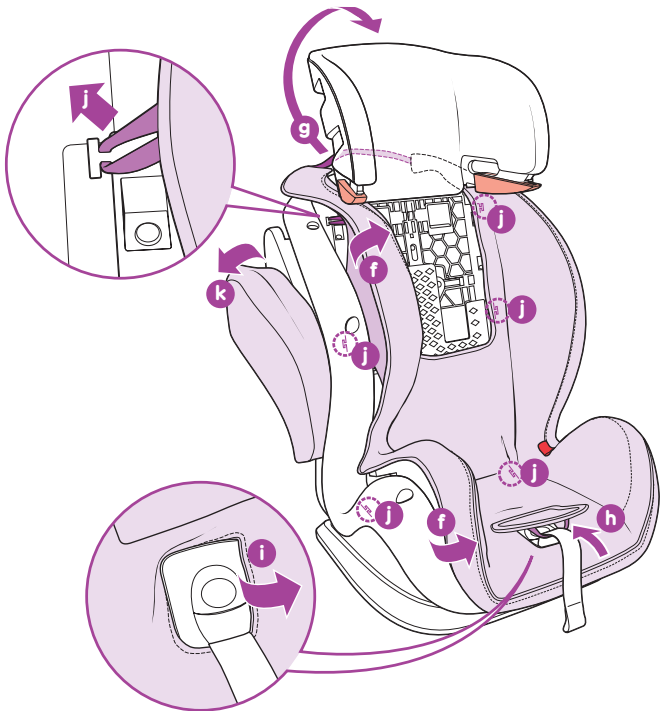
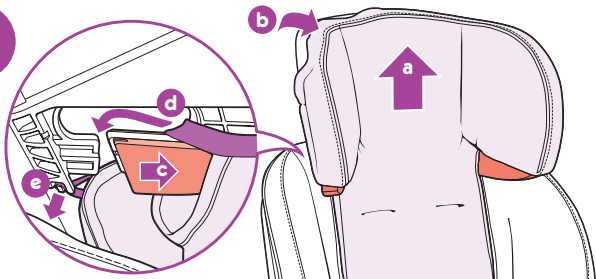

16

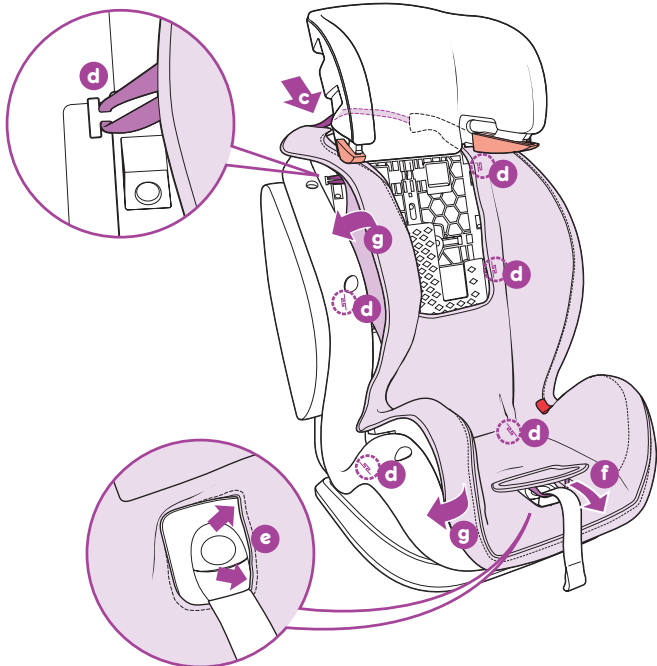
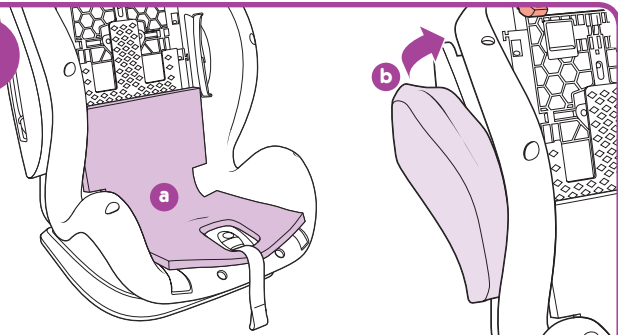

17

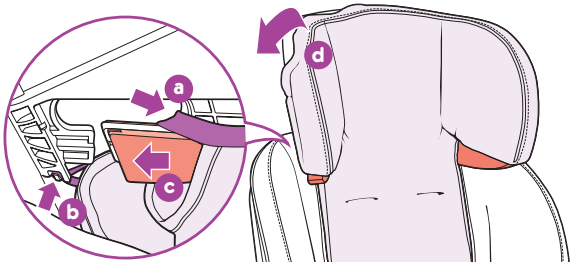

18

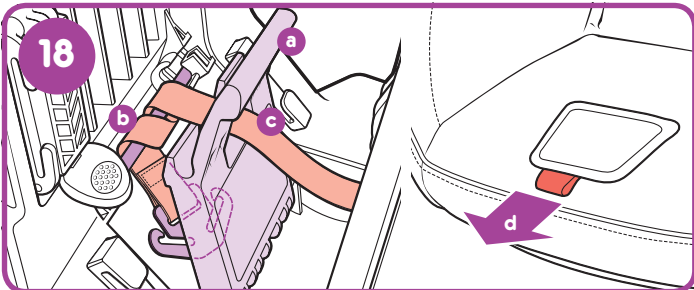

19

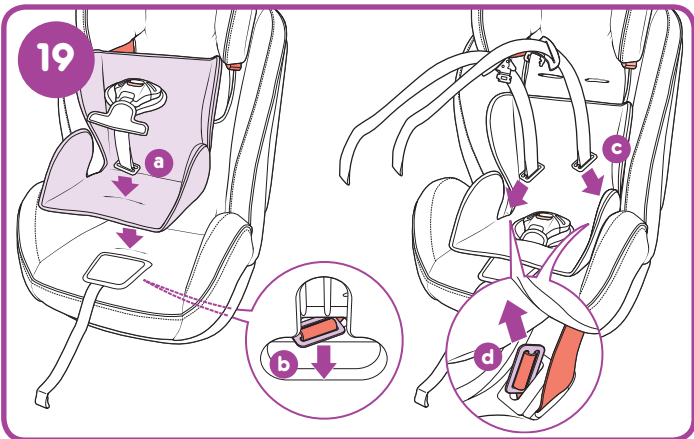

20

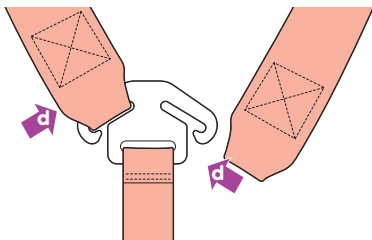
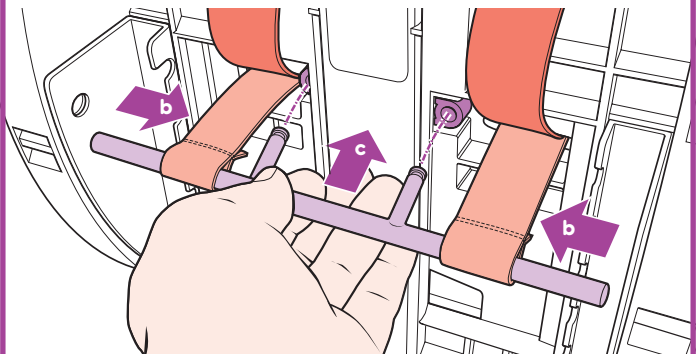
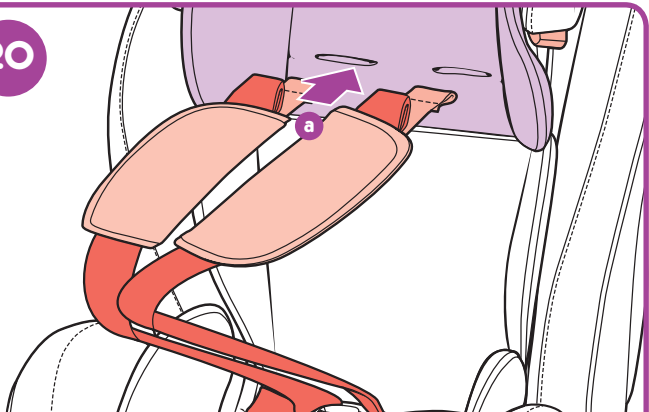

SIGN UP SIGN UP



join our VIP club...
catch onto the newsletter at cosatto.com

Keep in the lovely loop...
for regular crazy competitions, exclusive
viewings of future stuff, grooviest giveaways
and exclusive invitations. Tell your friends too...



recommend
3 friends
to
win...

scan the QR
code to enter



log onto
cosatto.com/3twin

Join the
brightest
anbase



follow us on...
facebook.com/clubcosatto

tweet
tweet



join the conversation...
[@Cosatto_Tweets](https://twitter.com/Cosatto_Tweets)

